

2 Glass Door Reach-In Refrigerator



BGM-35

Features

Bottom Mounted Compressor

The bottom mounted compressor allows for easy access while loading, unloading, maintenance and cleaning. Also due to the temperature difference between the bottom and the top of the room this compressor location is superior to the top mounted style.

2 Anti-Fog Self Closing Doors

Fully insulated glass doors while providing clear visibility of products inside also helps keep energy costs down by not allowing as much cold air to escape the unit while opening.

8 Adjustable Interior Shelves

The interior shelves sit on adjustable mounting brackets; accommodating for different sized products with shelf by shelf height adjustments.

Digital Temperature Controls

The LCD display allows for easy visual read out and temperature control.

4 Casters

Including 2 pre-installed front locking casters for easy set up and moving during cleaning or maintenance.

LED Lighting

The light-emitting diode(LED) lighting provides high visibility for customer's viewing.

Models	Doors	#of Shelves	Compressor (H/P)	Voltage (v/Hz)	Gross Weight	Exterior Dims (Ins)
BGM-35	2	8	1/3	115/60	345lbs	44.5" x 28.3" x 79.3"

Technical Data

Plan View

Dimensions

Exterior Dimensions (Inches)	44.5" x 28.3" x 79.3"
Interior Dimensions (Inches)	40.7" x 21.5" x 61.5"
Packaging Dimensions (Inches)	46.5" x 30.3" x 82.7"
Capacity (cu. ft.)	35 cu. ft.
Gross Weight	345 lbs

Construction

Exterior Material	Painted steel
Interior Material	Painted Aluminum
Door/Lid Material	Glass Door
Insulation Material	Cyclopentane
# of Doors	2
Self Closing Door	Yes
Lock Mounted	Yes
# of Shelves	8
Shelf Material	Plastic coated steel
Shelf Load Capacity	90 lbs

Cooling

Temperature Range	33° - 40° F
Refrigerant	R290
Maximum Ambient Temperature Rating	90° F
Defrosting	Automatic
Temperature Display	Yes
Temperature Controller	Digital
Cooling System	Ventilated
Compressor H/P	1/3

Electrical

Voltage (v/Hz)	115/60
Amps	9.5

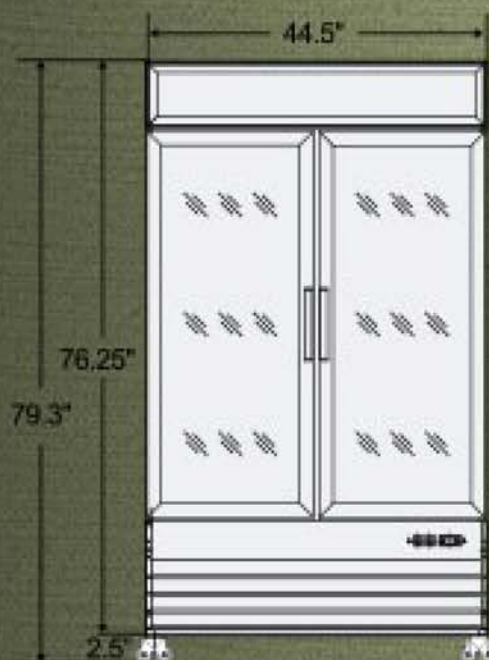

Front View

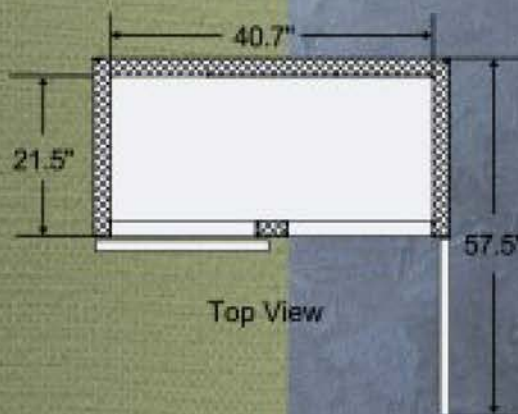

Top View



Side View



NEMA 5-15P

