

TECHNICAL DATA

Dimensions

Exterior Dimensions (WxDxH)	72.75" x 24.375" x 35.625"
Interior Dimensions (WxDxH)	60.125" x 18.5" x 30.5"
Net Volume (cu. ft.)	19.6 cu. ft.
Gross Weight	283 lbs
Packaging Dimensions (WxDxH)	75.2" x 27.6" x 41.7"

Cooling

Temperature Range	33° - 40° F
Refrigerant	R290
Maximum Ambient Temperature Rating	90° F
Defrosting	Automatic
Temperature Display	Yes
Temperature Controller	Digital
H/P	1/3+

Construction

Exterior Material	430 series stainless steel
Interior Material	304 series stainless steel
Insulation Material	Foamed in place polyurethane
Shelf Load Capacity	90 lbs
Handles only on Models	SGBBB-72/SSGGBB-72

Electrical

Voltage	115
Amps	8
Hz	60
Phase	1

PLAN VIEW



COMPLIES WITH ANSI/NSF 7 FOR FOOD SERVICE

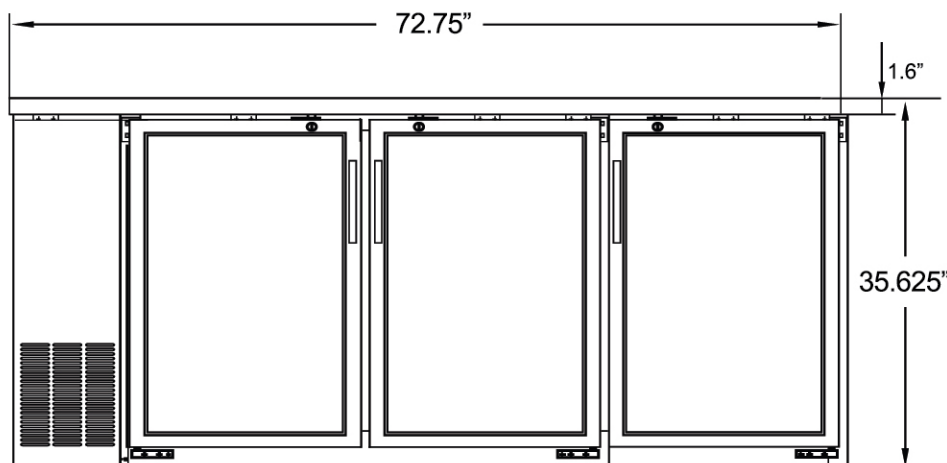

Front View

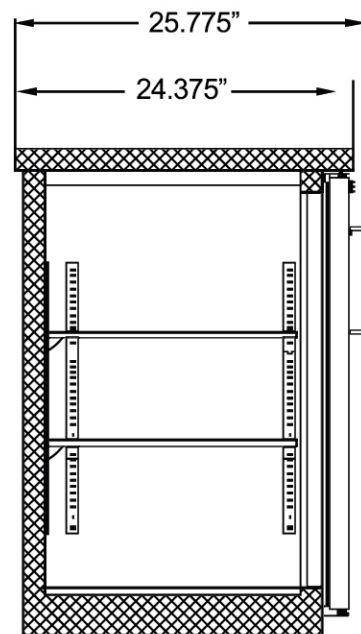

Side View

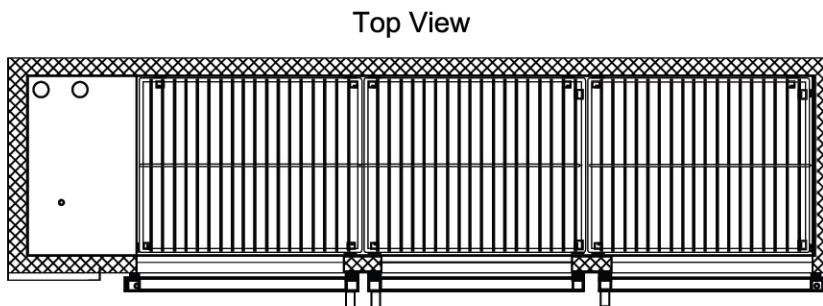

Top View

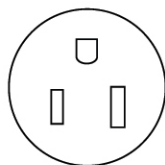

NEMA 5-15

72" Back Bar W / Anti-Fog Glass Doors

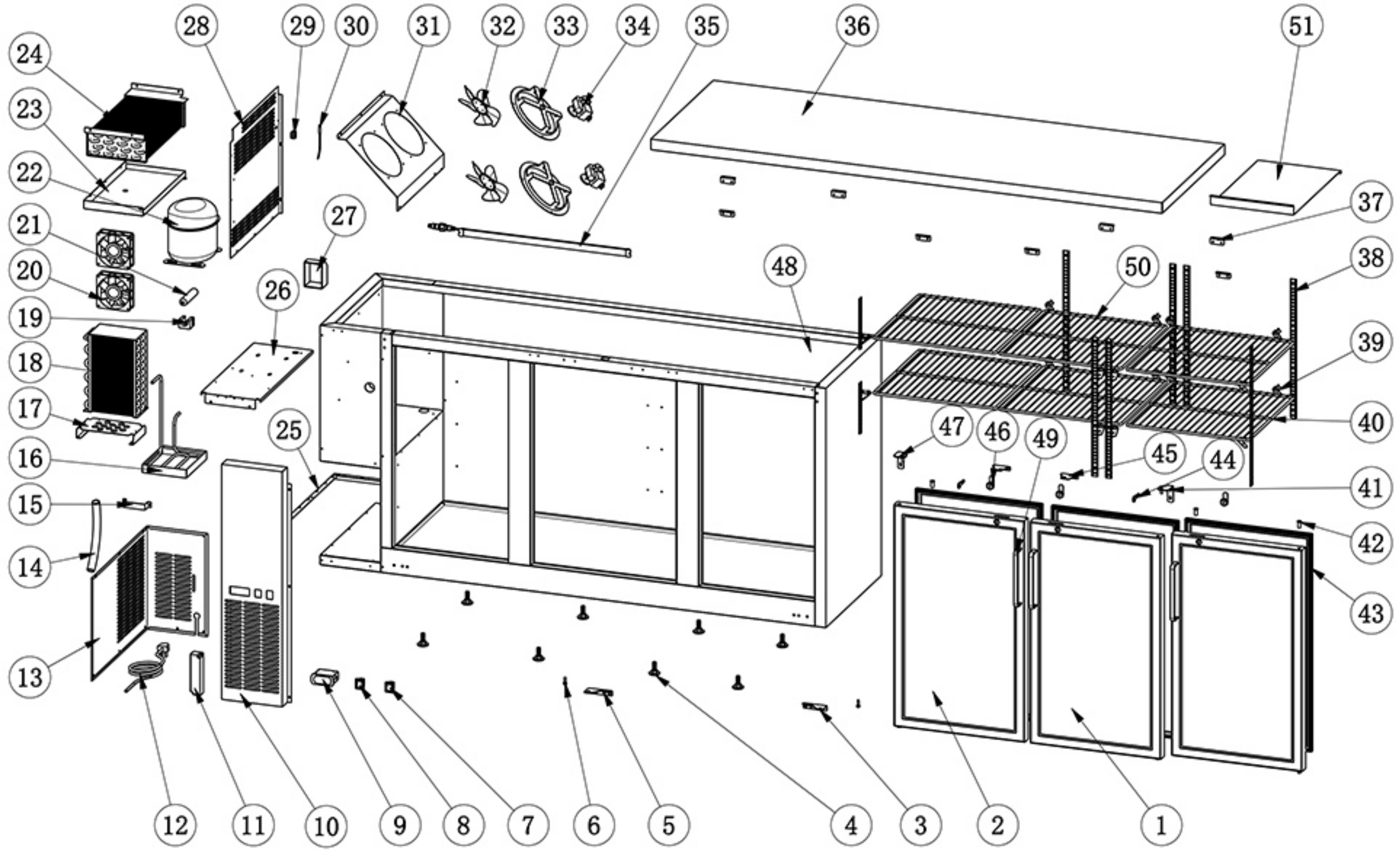

SSGGB-72

NO.	Part Name	Factory Part NO.	QTY
1	RIGHT GLASS DOOR	14201010017	2
2	LEFT GLASS DOOR	14201010018	1
3	BOTTOM RIGHT HINGE	12517140003	2
4	LEVELING FEET	12534030002	8
5	BOTTOM LEFT HINGE	12517140005	1
6	BOTTOM HINGE AXIS	12515030002	3
7	POWER SWITCH	17749211297	1
8	LED LIGHT SWITCH	17749180002	1
9	THERMOSTAT	17505180005	1
10	CONTROL PANNEL		1
11	LED POWER SUPPLY	22753530013	1
12	POWER CORD	17664640064	1
13	BACK GRILL		1
14	DRAIN HOSE	15818180020	1
15	HANDLE OF COMPRESSOR INSTALLATION BOARD		1
16	OUTER DRAIN PAN	16316130005	1
17	CONDENSER INSTALLATION BOARD		1
18	CONDENSER	17304110150	1
19	FILTER FIXER	16369690257	1
20	CONDENSER FAN MOTOR	22752520021	2
21	FILTER	17111250197	1
22	COMPRESSOR	17202163121	1
23	INNER DRAIN PAN		1
24	EVAPORATOR	17405080340	1
25	FIXED MOUNTS FOR BACK GRILL		1
26	COMPRESSOR INSTALLATION BOARD		11
27	COMPRESSOR COMPONENT		1
28	EVAPORATOR COVER		1
29	TEMPERATURE PROBE FIXER	16357060003	1
30	TEMPERATURE PROBE	17649490016	1
31	EVAPORATOR FAN INSTALLATION BOARD		1
32	EVAPORATOR FAN BLADE	16381738082	1
33	EVAPORATOR FAN HOLDER	12504050201	1
34	EVAPORATOR FAN MOTOR	22752520007	1
35	LED LIGHT	17740410069	1
36	TOP BOARD		1
37	TOP BOARD FIXER		8
38	K STRIP		12
39	K CLIP	5302000003	24
40	SHELF/LEFT AND RIGHT	12502460487	4
41	UPPER RIGHT HINGE		2

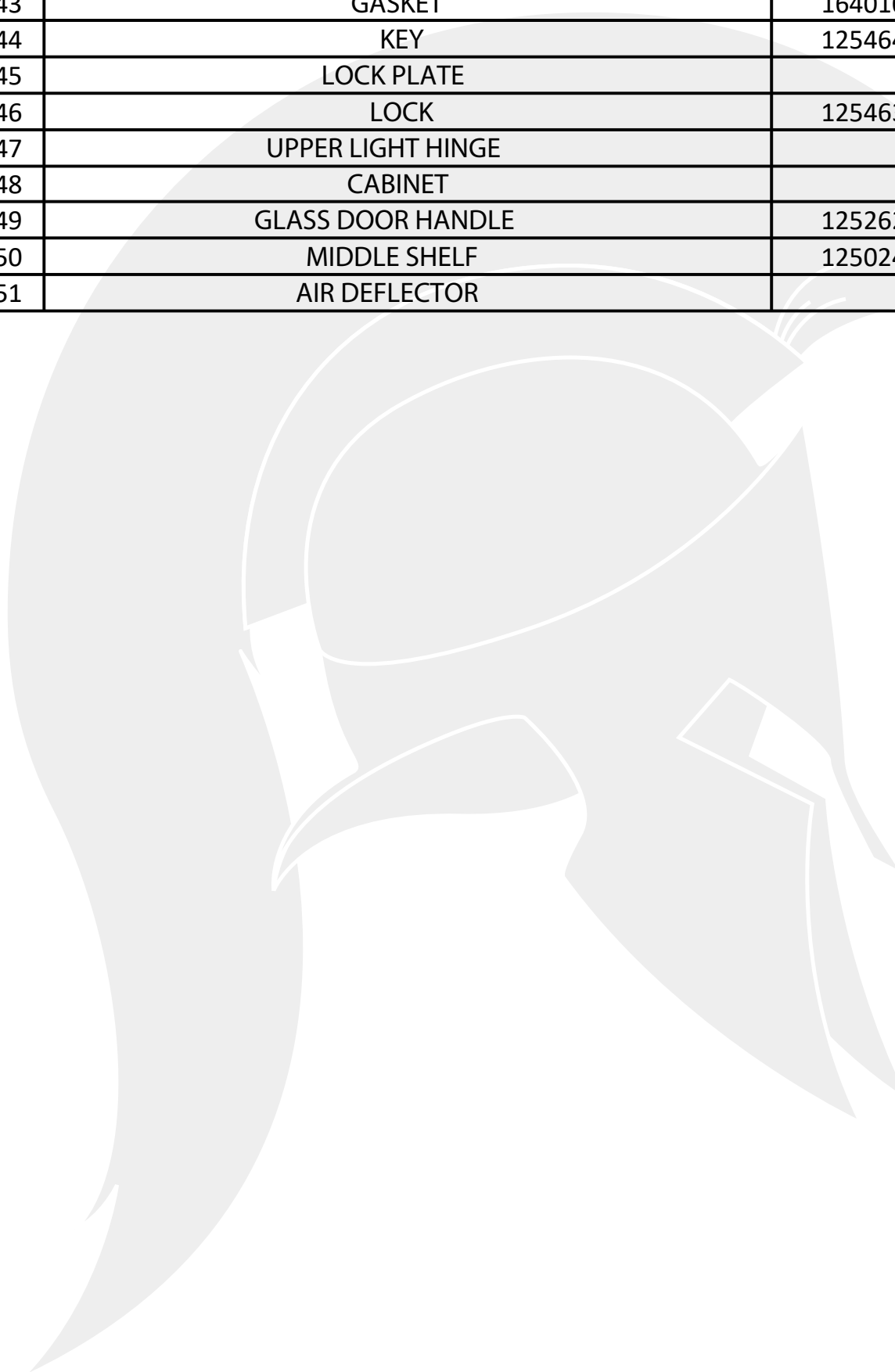

42	AXIS COVER	16353010008	6
43	GASKET	16401000072	3
44	KEY	12546460001	3
45	LOCK PLATE		3
46	LOCK	12546310004	3
47	UPPER LIGHT HINGE		1
48	CABINET		1
49	GLASS DOOR HANDLE	12526260021	3
50	MIDDLE SHELF	12502460522	2
51	AIR DEFLECTOR		1

NO.	Part Name	Factory Part NO.	QTY
1	RIGHT GLASS DOOR	14201010017	2
2	LEFT GLASS DOOR	14201010018	1
3	BOTTOM RIGHT HINGE	12517140003	2
4	LEVELING FEET	12534030002	8
5	BOTTOM LEFT HINGE	12517140005	1
6	BOTTOM HINGE AXIS	12515030002	3
7	POWER SWITCH	17749211297	1
8	LED LIGHT SWITCH	17749180002	1
9	THERMOSTAT	17505180005	1
10	CONTROL PANNEL		1
11	LED POWER SUPPLY	22753530013	1
12	POWER CORD	17664640064	1
13	BACK GRILL		1
14	DRAIN HOSE	15818180020	1
15	HANDLE OF COMPRESSOR INSTALLATION BOARD		1
16	OUTER DRAIN PAN	16316130005	1
17	CONDENSER INSTALLATION BOARD		1
18	CONDENSER	17304110150	1
19	FILTER FIXER	16369690257	1
20	CONDENSER FAN MOTOR	22752520021	2
21	FILTER	17111250197	1
22	COMPRESSOR	17202163121	1
23	INNER DRAIN PAN		1
24	EVAPORATOR	17405080340	1
25	FIXED MOUNTS FOR BACK GRILL		1
26	COMPRESSOR INSTALLATION BOARD		11
27	COMPRESSOR COMPONENT		1
28	EVAPORATOR COVER		1
29	TEMPERATURE PROBE FIXER	16357060003	1
30	TEMPERATURE PROBE	17649490016	1
31	EVAPORATOR FAN INSTALLATION BOARD		1
32	EVAPORATOR FAN BLADE	16381738082	1
33	EVAPORATOR FAN HOLDER	12504050201	1
34	EVAPORATOR FAN MOTOR	22752520007	1
35	LED LIGHT	17740410069	1
36	TOP BOARD		1
37	TOP BOARD FIXER		8
38	K STRIP		12
39	K CLIP	5302000003	24
40	SHELF/LEFT AND RIGHT	12502460487	4
41	UPPER RIGHT HINGE		2

42	AXIS COVER	16353010008	6
43	GASKET	16401000072	3
44	KEY	12546460001	3
45	LOCK PLATE		3
46	LOCK	12546310004	3
47	UPPER LIGHT HINGE		1
48	CABINET		1
49	GLASS DOOR HANDLE	12526260021	3
50	MIDDLE SHELF	12502460522	2
51	AIR DEFLECTOR		1

NO.	Part Name	Factory Part NO.	QTY
1	RIGHT DOOR		2
2	LEFT DOOR		1
3	BOTTOM RIGHT HINGE	12517140003	2
4	LEVELING FEET	12534030002	8
5	BOTTOM LEFT HINGE	12517140005	1
6	BOTTOM HINGE AXIS	12517010001	3
7	POWER SWITCH	17749211297	1
8	LED LIGHT SWITCH	17749180002	1
9	THERMOSTAT	17505180005	1
10	CONTROL PANNEL		1
11	LED POWER SUPPLY	22753530013	1
12	POWER CORD	17664640064	1
13	BACK GRILL		1
14	DRAIN HOSE	15818180020	1
15	HANDLE OF COMPRESSOR INSTALLATION BOARD		1
16	OUTER DRAIN PAN	16316130005	1
17	CONDENSER INSTALLATION BOARD		1
18	CONDENSER	17304110150	1
19	FILTER FIXER	16369690257	1
20	CONDENSER FAN MOTOR	22752520021	2
21	FILTER	17111250197	1
22	COMPRESSOR	17202163121	1
23	INNER DRAIN PAN		1
24	EVAPORATOR	17405080340	1
25	FIXED MOUNTS FOR BACK GRILL		1
26	COMPRESSOR INSTALLATION BOARD		11
27	COMPRESSOR COMPONENT		1
28	EVAPORATOR COVER		1
29	TEMPERATURE PROBE FIXER	16357060003	1
30	TEMPERATURE PROBE	17649490016	1
31	EVAPORATOR FAN INSTALLATION BOARD		1
32	EVAPORATOR FAN BLADE	16381738082	1
33	EVAPORATOR FAN HOLDER	12504050201	1
34	EVAPORATOR FAN MOTOR	22752520007	1
35	LED LIGHT	17740410069	1
36	TOP BOARD		1
37	TOP BOARD FIXER		8
38	K STRIP		12
39	K CLIP	5302000003	24
40	SHELF/LEFT AND RIGHT	12502460487	4
41	UPPER RIGHT HINGE		2



42	AXIS COVER	16353010008	6
43	GASKET	16401478763	3
44	KEY	12546310002	3
45	LOCK PLATE		3
46	LOCK	12546100952	3
47	UPPER LIGHT HINGE		1
48	CABINET		1
49	DOOR HANDLE	16337030003	3
50	MIDDLE SHELF	12502460522	2
51	AIR DEFLECTOR		1

SBBB-72

NO.	Part Name	Factory Part NO.	QTY
1	RIGHT DOOR		2
2	LEFT DOOR		1
3	BOTTOM RIGHT HINGE	12517140003	2
4	LEVELING FEET	12534030002	8
5	BOTTOM LEFT HINGE	12517140005	1
6	BOTTOM HINGE AXIS	12517010001	3
7	POWER SWITCH	17749211297	1
8	LED LIGHT SWITCH	17749180002	1
9	THERMOSTAT	17505180005	1
10	CONTROL PANNEL		1
11	LED POWER SUPPLY	22753530013	1
12	POWER CORD	17664640064	1
13	BACK GRILL		1
14	DRAIN HOSE	15818180020	1
15	HANDLE OF COMPRESSOR INSTALLATION BOARD		1
16	OUTER DRAIN PAN	16316130005	1
17	CONDENSER INSTALLATION BOARD		1
18	CONDENSER	17304110150	1
19	FILTER FIXER	16369690257	1
20	CONDENSER FAN MOTOR	22752520021	2
21	FILTER	17111250197	1
22	COMPRESSOR	17202163121	1
23	INNER DRAIN PAN		1
24	EVAPORATOR	17405080340	1
25	FIXED MOUNTS FOR BACK GRILL		1
26	COMPRESSOR INSTALLATION BOARD		11
27	COMPRESSOR COMPONENT		1
28	EVAPORATOR COVER		1
29	TEMPERATURE PROBE FIXER	16357060003	1
30	TEMPERATURE PROBE	17649490016	1
31	EVAPORATOR FAN INSTALLATION BOARD		1
32	EVAPORATOR FAN BLADE	16381738082	1
33	EVAPORATOR FAN HOLDER	12504050201	1
34	EVAPORATOR FAN MOTOR	22752520007	1
35	LED LIGHT	17740410069	1
36	TOP BOARD		1
37	TOP BOARD FIXER		8
38	K STRIP		12
39	K CLIP	5302000003	24
40	SHELF/LEFT AND RIGHT	12502460487	4
41	UPPER RIGHT HINGE		2



42	AXIS COVER	16353010008	6
43	GASKET	16401478763	3
44	KEY	12546310002	3
45	LOCK PLATE		3
46	LOCK	12546100952	3
47	UPPER LIGHT HINGE		1
48	CABINET		1
49	DOOR HANDLE	16337030003	3
50	MIDDLE SHELF	12502460522	2
51	AIR DEFLECTOR		1