

# SGM-72RS

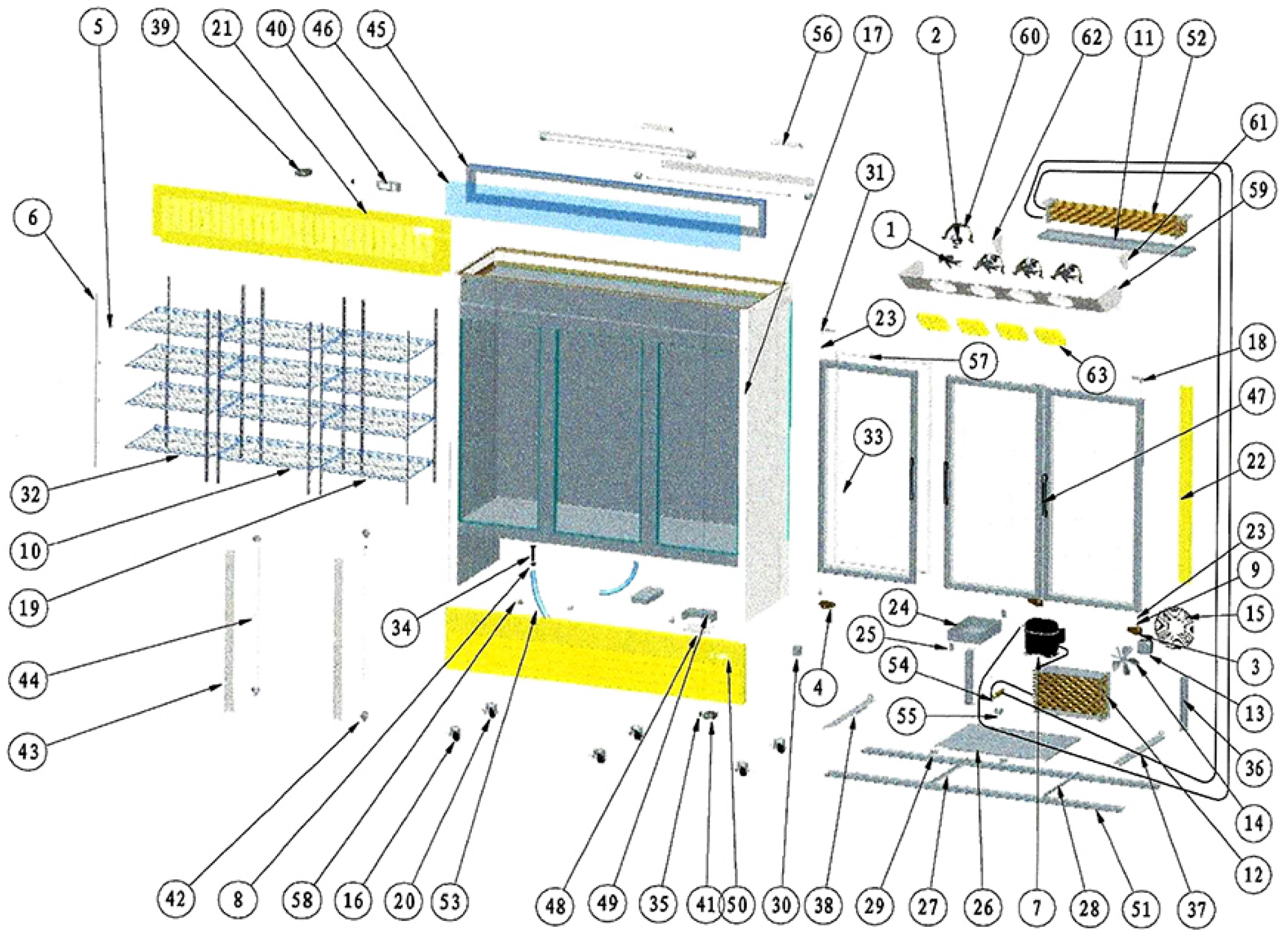

<b>Part #</b>	<b>Part Name</b>	<b>Part Qty</b>
1	Blade Evaporator Fan Motor	4
2	Evaporator Fan Motor (AL152-2524)	4
3	Right Bottom Hinge	2
4	Left Bottom Hinge	1
5	K Clip (8 Holes)	48
6	K Strip	12
7	Compressor (T5217Z)	1
8	Drain Pipe Cover	1
9	Bottom Hinge Axis	3
10	Middle Shelf	4
11	Inner Drain Pan	1
12	Condenser (4R11K400L)	1
13	Condenser Fan Motor (M4Q045 CF07-04)	1
14	Condenser Fan Motor Blade (254 V28)	3
15	Condenser Fan Motor Cover	1
16	Front Caster With Brake	3
17	Cabinet	4
18	Right Upper Hinge	3
19	Right Shelf	4
20	Back Caster Without Brake	3
21	Back Grill	1
22	Air Return Cover Pipe	1
23	Plastic Axis Cover	6
24	Outer Drain Pan	1
25	Outer Drain Pan Fixer	2
26	Installation Board	1
27	Right Track For Installation Board	1
28	Left Track For Installation Board	1
29	Installation Board Limited Block	2
30	Small Size Digital Display Transformer	1
31	Left Upper Hinge	1
32	Left Shelf	4
33	Left Glass Door	1
34	Plastic Drain Hose	1
35	Power Switch (Red)	2
36	Supporting Board	2
37	Right Connecting Boar For Caster	1

38	Left Connecting Board For Caster	1
39	Thermostat (CAREL PJEZ)	1
40	Thermostat Box	1
41	Small Digital Display Of Temperature	1
42	Lamp Holder	8
43	Lamp Installation Board	4
44	Lamp	4
45	Lamp Box Frame	1
46	Lamp Box Plate	1
47	Handle Of Glass Door	2
48	Base Board Of Electrical Box	1
49	Lid Of Electrical Box	1
50	Front Grill	1
51	Leg Supporter	2
52	Evaporator (4R11K400L)	1
53	Drain Hose	2
54	Filter (25x187)	1
55	Filter Fixer	1
56	Ballast	2
57	Gasket	2
58	Tough Switch	3
59	Evaporator Cover	1
60	Evap. Fan Motor Fixer	4
61	Right Clapboard For Evap. Fan Motor	1
62	Left Clapboard For Evap. Fan Motor	1
63	Evap. Fan Motor Cover	4

# TECHNICAL DATA

## Dimensions

Exterior Dimensions (WxDxH)	78.3" x 30" x 80.7"
Interior Dimensions (WxDxH)	73.7" x 25.6" x 49"
Net Volume (cu. ft.)	69 cu. ft.
Gross Weight	615 lbs
Packaging Dimensions (WxDxH)	80.5" x 32" x 87"

## Cooling

Temperature Range	33° - 40° F
Refrigerant	R290
Maximum Ambient Temperature Rating	90° F
Defrosting	Automatic
Temperature Display	No
Temperature Controller	Mechanical
H/P	1/2

## Construction

Exterior Material	Painted steel
Door/Lid Material	Glass Door
Insulation Material	Foamed in place polyurethane
Shelf Material	Plastic coated steel
Shelf Load Capacity	90 lbs

## Electrical

Voltage	120
Amps	13.1
Hz	60
Phase	1

## PLAN VIEW

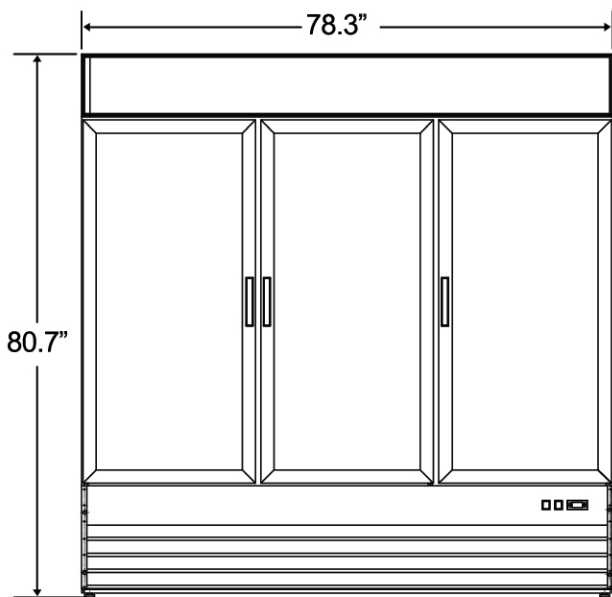

Front View

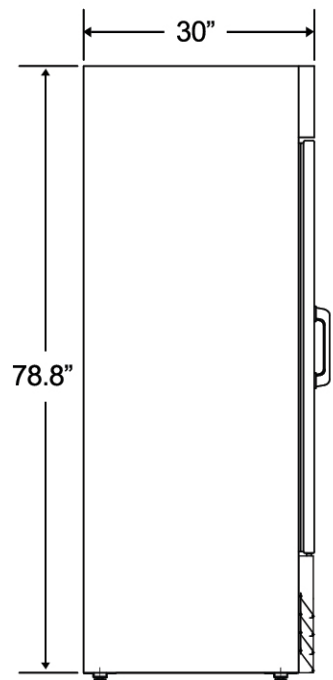

Side View

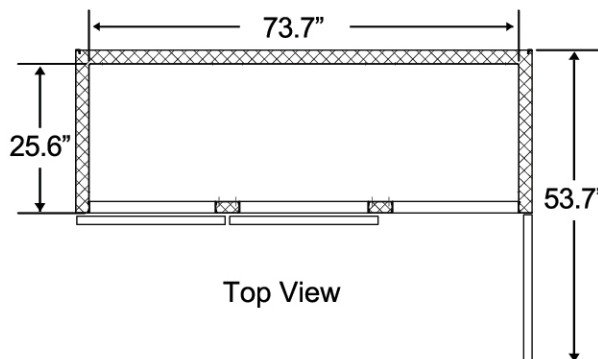

Top View

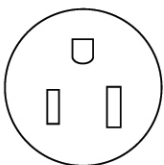

NEMA 5-15