

Sandwich Press Hinge Tension Adjustment

Models 40794, 40794C, 40795, 40795C

HINGE ADJUSTMENT PROCEDURE

Perform this adjustment after use and cleaning procedures have been completed.

1. Tighten the bolt (B) to secure the rear axle shaft (D) to the handle (C). See Figure 1. Repeat on the other side.
2. Remove the hinge axle cover (A).
3. Apply a small amount of food grade grease to the hole (E) in the brass saddle clamp (G).
4. Tighten the bolts (F) fully.
5. Loosen each of the bolts (F) 1/4 of a turn and check the resistance of the cover. Do not loosen the bolts (F) more than 1-1/2 turns.
6. Tighten the capscrew (H) to increase the return spring pressure.
7. Repeat steps 5 and 6 until the desired results are achieved.
8. Install the hinge axle cover (A) securing with original hardware.

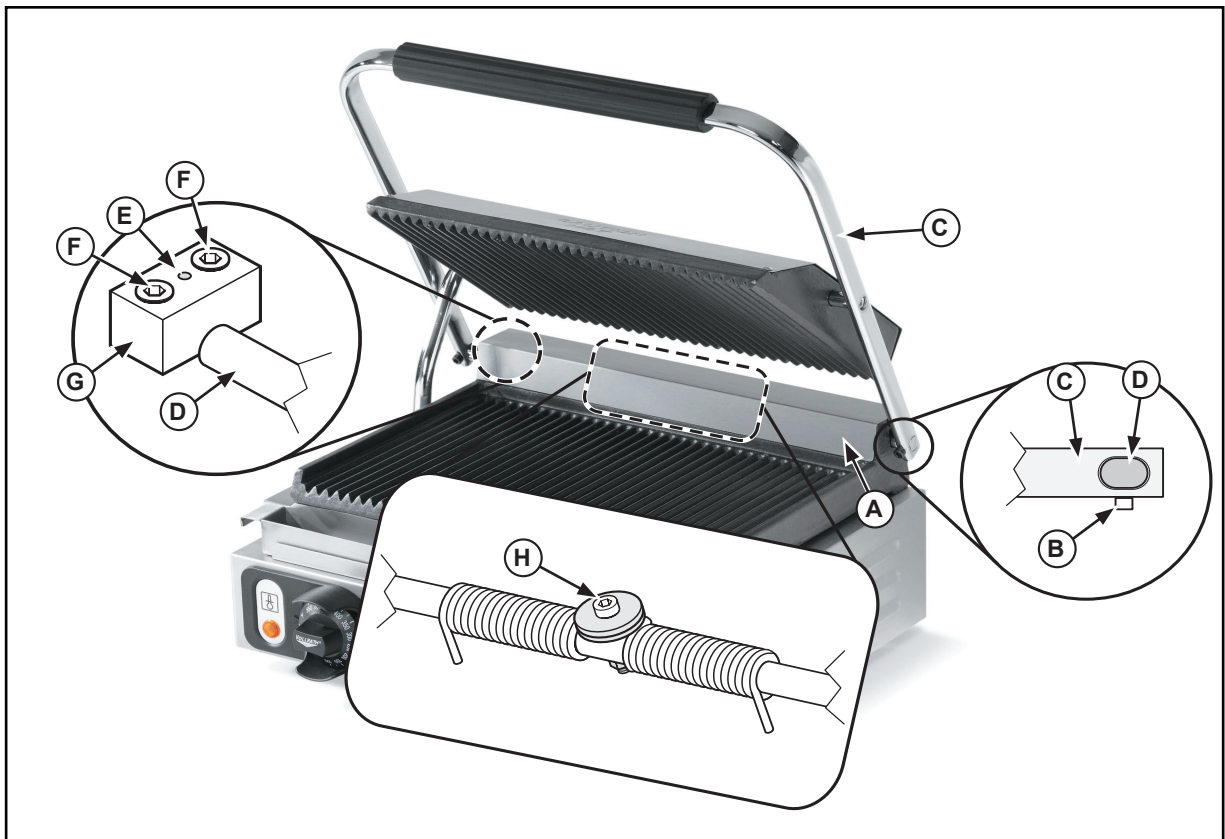

Figure 1. Handle and Hinge Components.



www.vollrathco.com

The Vollrath Company, L.L.C.
1236 North 18th Street
Sheboygan, WI 53081-3201
U.S.A.

Main Tel: 800.628.0830
Fax: 800.752.5620

Technical Services: 800.628.0832
Service Fax: 920.459.5462

Canada Service: 800.695.8560

© 2011 The Vollrath Company, L.L.C.

